

NOTES:

1. MATERIAL: NYLON 6T, BLACK, UL94V-0.
2. CONTACT: PHOSPHOR BRONZE, $t=0.15\pm0.01\text{mm}$, 15u" GOLD PLATED.
3. METAL TAB: PHOSPHOR BRONZE, $t=0.15\pm0.01\text{mm}$, 120u" TIN/LEAD PLATED.

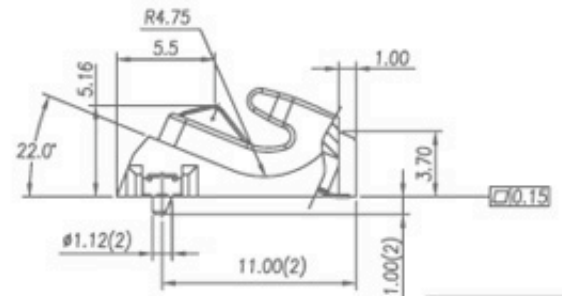
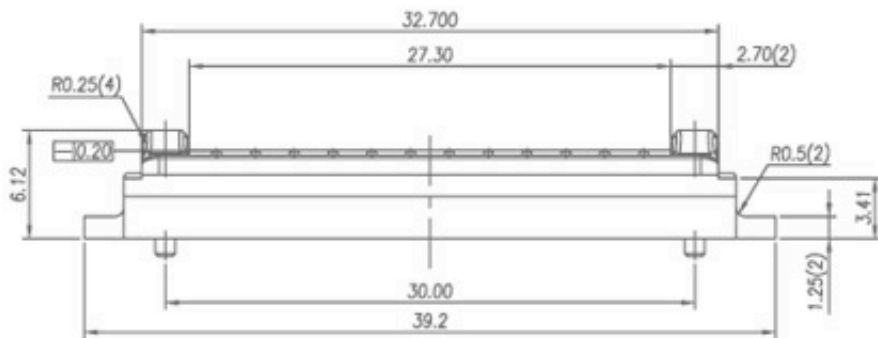

CAD NO. MCNT21140012-0C

APPROVED BY:	CUSTOMER SIGNATURE
DATE:	

REV.	DESCRIPTION	DATE

STAMP PART NO. IN AREA INDICATED BY "X"	MFL:
UNLESS OTHERWISE SPECIFIED SURFACE FINISH ALL OVER TOLERANCES	HEAT TREAT
INCH METRIC	COAT/G OR PLAT/G
0.0 = ±0.07	REQ'D:
0.00 = ±0.01	D.R. Gavin 1/30/01
0.005 = ±0.005	CHK
0.0005 = ±0.001	APVD
0.07 = ±1"	
0.007 = ±0.5"	

CYPRESS INDUSTRIES				PRODUCT NO. OR LAYOUT
www.cypressindustries.com				
TITLE			SLINKY DOCK CONN 12POS	
SCALE	SIZE	NO.	DET. NO	REV.
4:1	A3	MCNT21140012-0	C	3
				SH.T NO. 1 OF 1